

720N - Valvola a sfera in 2 pezzi filettata corpo forgiato passaggio totale

Rating: 800 - 3000 Ps.i.

720N - Threaded floating 2 pieces ball valve forged body full bore

Rating: 800 - 3000 Ps.i.

Features disponibili / Available features:

- Nippli SW / Nipples with SW ends;
- Nippli BW / Nipples with BW ends;
- Nippli piani / Nipples with plain ends;
- Gas/Npt filettate maschio femmina / Gas/Npt male/female thread;
- Dispositivo di arresto / Locking device;
- ISO top mounting a richiesta / ISO top mounting on request.

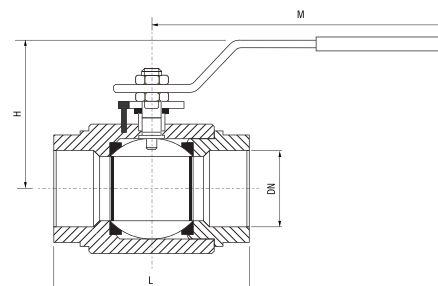
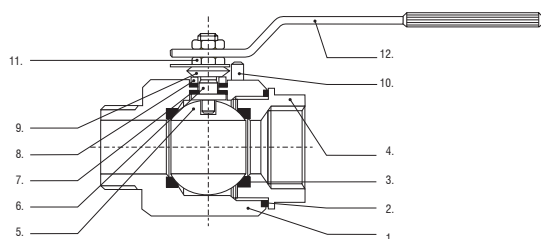

Dimensioni / Dimensions

Dimensioni in mm / Dimensions in mm

Dimensione / Size	1/4"	3/8"	1/2"	3/4"	1"	1 1/4"	1 1/2"	2"
L	67	67	75	90	105	120	135	155
H	48	48	49	55	69	77	84	93
M	148	148	148	180	180	240	240	280
Peso / Weight kg.	0,6	0,6	0,8	1,5	2	3,3	4,5	6

Descrizione & Materiali / Description & Materials

POS	Descrizione / Description	Materiale / Material		Parti di ricambio / Spare parts (QTY)
1	Corpo / Body	ASTM A105	ASTM A 182 F 316	
2	Guarnizione Corpo / Body gasket	PTFE	PTFE	
3	Sede / Seat	RPTFE/Nylon	RPTFE/Nylon	1
4	Cap / Cap	ASTM A105	ASTM A 182 F 316	
5	Sfera / Ball	ASTM A 182 F 316	ASTM A 182 F 316	Su Richiesta / On Request
6	Stelo / Stem	ASTM A 182 F 316	ASTM A 182 F 316	
7	Stem Guarnizione / Stem gasket	PTFE	PTFE	1
8	Premibussola / Gland	Galvanized Steel	Galvanized Steel	
9	Rondella / Washer	C72	50 CrV4	
10	Fermo / Pin	Galvanized Steel	Galvanized Steel	Su Richiesta / On Request
11	Dado / Nut	A 194 Gr1	A 194 Gr1	
12	Leva / Lever	Galvanized Steel PVC Handle	Galvanized Steel PVC Handle	Su Richiesta / On Request