

Attacchi rapidi

Gli attacchi rapidi a leva sono ideati per collegamenti rapidi e sicuri tra due tubazioni.

È sufficiente inserire l'adattatore maschio nella femmina in modo che il bordo appoggi sulla guarnizione di tenuta alloggiata all'interno del raccordo femmina.

Abbassando la leva si ottiene una chiusura a perfetta tenuta. Le parti terminali degli innesti rapidi possono essere a saldare di testa o a tasca con filettatura femmina o maschio (ANSI - UNI - WITHWORTH) flangiati o con codulo portagomma.

Swift connection

The swift connection levers are appropriate for quick and secure links between two pipelines. It is sufficient to insert the border can support the capacity of the packing lodged into the female internal.

Lowering the lever it's possible to obtain a perfect capacity.

The swift connection external parties could be welded on their head or the suckered with a female or male thread (ANSI - UNI - WITHWORTH) flanges or with tang gum carrier.

It's sufficient to insert the male adapter into the internal female in such a way the border can support the capacity of the packing.

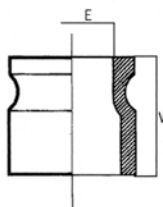

AW

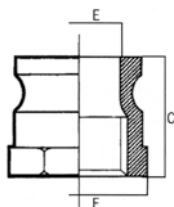

A

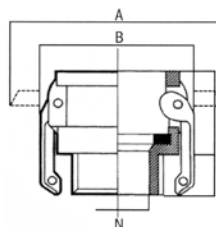

B

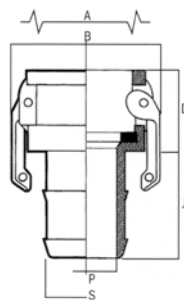

C

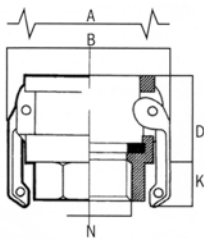

D

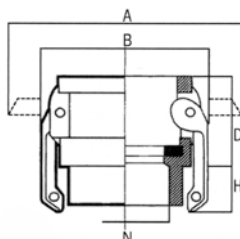

DW

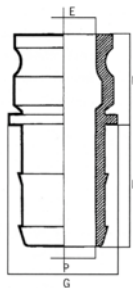

E

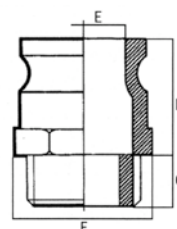

F

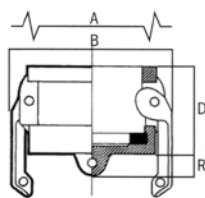

L

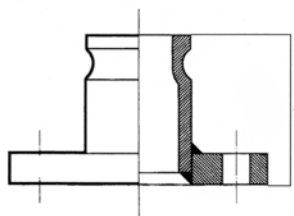

LAS

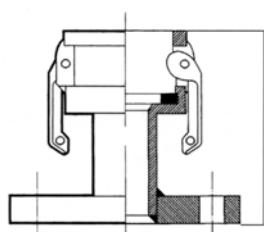

LBS

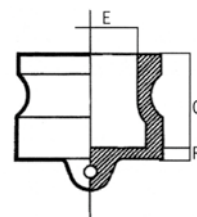

P



Attacchi rapidi

Materiali degli attacchi

Alluminio, bronzo, acciaio inox 304 - 316L, polipropilene.

Materiale delle guarnizioni

Buna, Viton Dutral, neoprene, PTFE- Diflex.

Diametri

DN 1/2" ÷ 10"

Swift connection

Material of the connection

Allumnus, bronze, steel inox 304 - 316L, polipropilene.

Material of the trimmings

Buna, Viton Dutrol, Neoprene, PTFE - Diflex.

Diameter

DN 1/2" ÷ 10"

Dim. Size	1/2"	3/4"	1"	1" 1/4	1" 1/2	2"	2" 1/2	3"	4"
A	117	117	137	184	191	200	213	254	279
B	53	53	58	72	81	92	115	125	155
C	38	38	48	56	56	62	74	74	75
D	32	32	40	50	50	54	56	58	60
E	15	19	24	28	36	46	58	72	98
F	32	34	38	46	55	70	83	98	124
G	34	34	38	50	57	72	86	103	130
H	18	18	24	24	24	26	32	32	32
I	40	40	48	55	56	63	69	71	77
J	72	82	100	106	106	122	136	158	186
K	18	18	20	22	24	24	26	30	30
L	40	50	56	58	60	70	80	100	116
M	28	33	44	52	54	58	61	66	67
N	15	20	24	30	40	50	60	75	90
O	28	28	36	42	47	53	53	53	53
P	10	14	20	25	32	42	56	66	93
R	8	8	10	10	10	11	11	11	11
S	16	21	26	34	42	52	68	80	103
T	65	65	71	80	86	95	100	102	110
U	70	70	88	104	105	120	130	150	160
V	38	38	48	50	56	60	74	74	75