

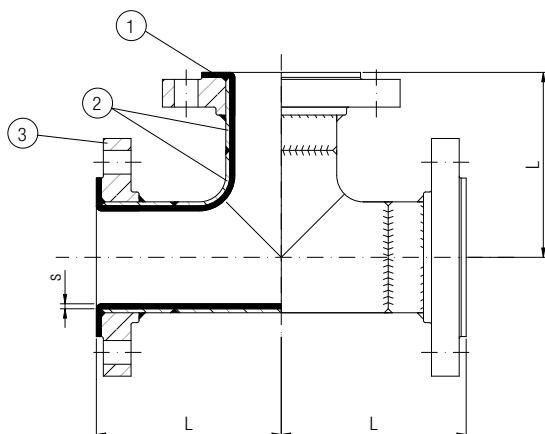

T uguali rivestiti in PTFE

- ASME/ANSI B16.5 Classe 150
- DN 1/2" - DN 24"
- Versione standard: 3 flange fisse
- Corpo in acciaio al carbonio
- Per grossi diametri soluzione in 2 parti



PTFE-lined equal tees

- ASME/ANSI B16.5 Class 150
- DN 1/2" - DN 24"
- Standard version: 3 fixed flanges
- Carbon steel body
- For big diameters solution in 2 parts

Materiali/Materials

- | | |
|----------|--------------------------|
| 1 | PTFE ASTM D-4894 or 4895 |
| 2 | St 37.0 - DIN 1629 |
| 3 | ASTM A 105 |

Fornibili a richiesta/Available on request

- Connessioni flangiate:
2 flange libere ed 1 flangia fissa o 3 flange libere
Flange connection:
2 loose flanges and 1 fixed flange or 3 loose flanges
- Flange ANSI B16.5 Classe 300/ANSI B16.5 - Class 300 flange
- Resistenza al vuoto/Vacuum resistance
- PTFE antistatico/Antistatic PTFE
- Corpo in acc. INOX/Stainless steel body
- Diametri superiori a richiesta/Higher diameters on request

DN	L mm	s mm	Peso ca. kg/Weight
1/2"	65	4,0	2,5
3/4"	75	4,5	3,2
1"	89	4,5	3,6
1 1/4"	95	5,5	4,7
1 1/2"	102	4,0	6,1
2"	114	4,75	9,7
2 1/2"	127	4,5	13,5
3"	140	5,8	21
4"	165	5,5	36
5"	190	5,0	57
6"	203	6,0	82
8"	229	6,0	121
10"	280	6,5	165
12"	305	6,5	228
14"	356	6,5	312
16"	381	6,5	375
18"	419	6,5	400
20"	457	6,5	420
24"	500	4,5	580