

Distanziali rivestiti in PTFE Tipo G

- DIN 2848/2874
- DN 15 - DN 600, PN 10
- Corpo in acciaio al carbonio

PTFE-lined spacers Type G

- DIN 2848/2874
- DN 15 - DN 600, PN 10
- Carbon steel body

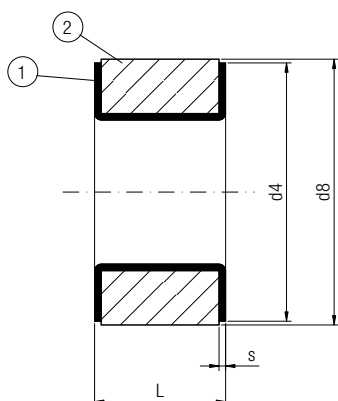

Materiali/Materials

- | | |
|---|--------------------------|
| 1 | PTFE ASTM D-4894 or 4895 |
| 2 | St 37.2 - DIN 17100 |

Fornibili a richiesta/Available on request

- Resistenti al vuoto/Vacuum resistance
- PTFE antistatico/Antistatic PTFE
- Corpo in acc. inox/Stainless steel body
- Diametri superiori a richiesta/Higher diameters on request

DN	L min. mm	L max. mm	s mm	d4 mm	d8 mm	Peso ca. kg/Weight
15	30	60	2,5	45	50	0,9
20	30	60	3	58	60	1,2
25	30	60	3	68	70	1,8
32	30	60	3	78	82	2,1
40	30	60	3	88	92	2,6
50	30	60	3	102	107	3,7
65	30	70	4	122	127	4,7
80	30	70	4	138	142	5,3
100	30	80	4,5	158	162	9,5
125	30	80	4,5	188	192	11
150	30	80	5	212	218	14
200	30	80	6,25	268	273	18
250	30	80	6,75	320	328	29
300	30	90	8	370	378	30
350	30	90	9	430	438	50
400	30	90	10	482	488	60
450	30	100	7,5	532	540	71
500	30	100	-	585	594	75
600	30	120	-	-	695	113