

**PTFE SOLID SPACER TYPE F
DESIGN DIN 2448/2874 - CERTIFIED- 2014/68/EU (PED)**

Standard Supply

Design:

DIN 2848/2874

Range:

DN 15 - DN 600, PN 10

Material:

← PTFE

Variants

Material:

← Antistatic PTFE



Spacer Type F
in Antistatic version

Available on request



Approvals and
Certifications



Quality and
Special tests



Engineering
Services



Special
Supply



Stainless steel
304L/316L
components



External
Finiture



DIN

index

previous view

D2-56

data sheet

DIFLINE

D2

PTFE SOLID SPACER TYPE F DESIGN DIN 2448/2874 - CERTIFIED- 2014/68/EU (PED)

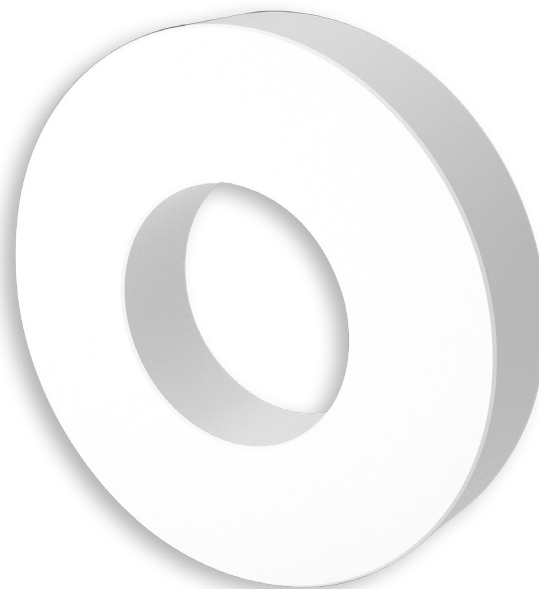
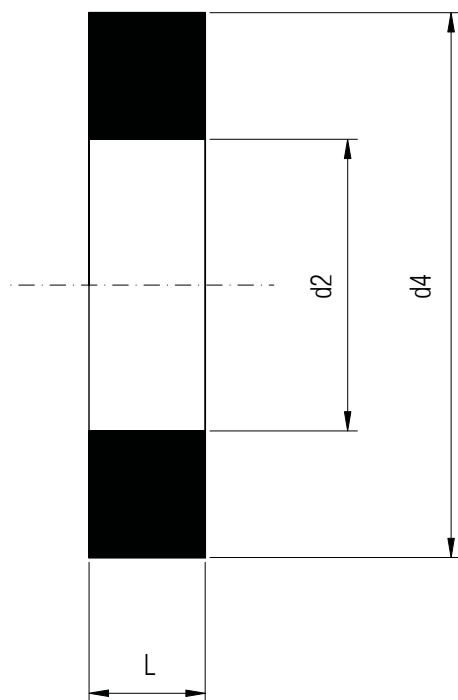

Dimension table

DN	L max. mm	d2 mm	d4 mm	weight kg
15	300	14	45	0,1
20	300	16	58	0,1
25	300	22	68	0,2
32	300	31	78	0,25
40	300	37	88	0,3
50	300	48	102	0,4
65	300	64	122	0,5
80	300	76	138	0,6
100	300	101	158	0,75
125	300	125	188	1,1
150	300	153	212	1,4
200	300	201	268	2,0
250	300	254	320	3,2
300	300	303	370	4,0
350	300	333	430	4,5
400	300	382	482	5,2
450	300	430	532	6,1
500	300	480	585	7,2

Technical specifications of Difline products



Pipes and Flanges dimensions according to DIN



Fittings dimensions according to DIN 2848



Operative Conditions



Bolt Torque



Finiture, Marking, Packing



Table of Chemical Resistance of Materials*