



DIN

index

previous view

D2-37

data sheet

DIFLINE

D2

## PTFE - PFA REDUCING TEE DESIGN DIN 2448/2874 - CERTIFIED - 2014/68/EU (PED)

### Standard Supply

#### Design:

DIN 2848/2874

Flange: 1 fixed + 2 free

#### Range:

DN 15 - DN 600, PN 10

#### Version A:

*With welded components*

body: P245GH EN 10216-217

flange: P245GH EN 1092-1

#### Version F:

fusion: GP240GH

#### Interior lining:

← PTFE

← PFA

### Variantis

#### Design:

for big diameters more than one piece will be provided

Flanges: 3 fixed

#### Metallic parts:

Stainless Steel 304L/316L

Low temp. steel P275NL

#### Interior lining:

← Antistatic PTFE

← Antistatic PFA

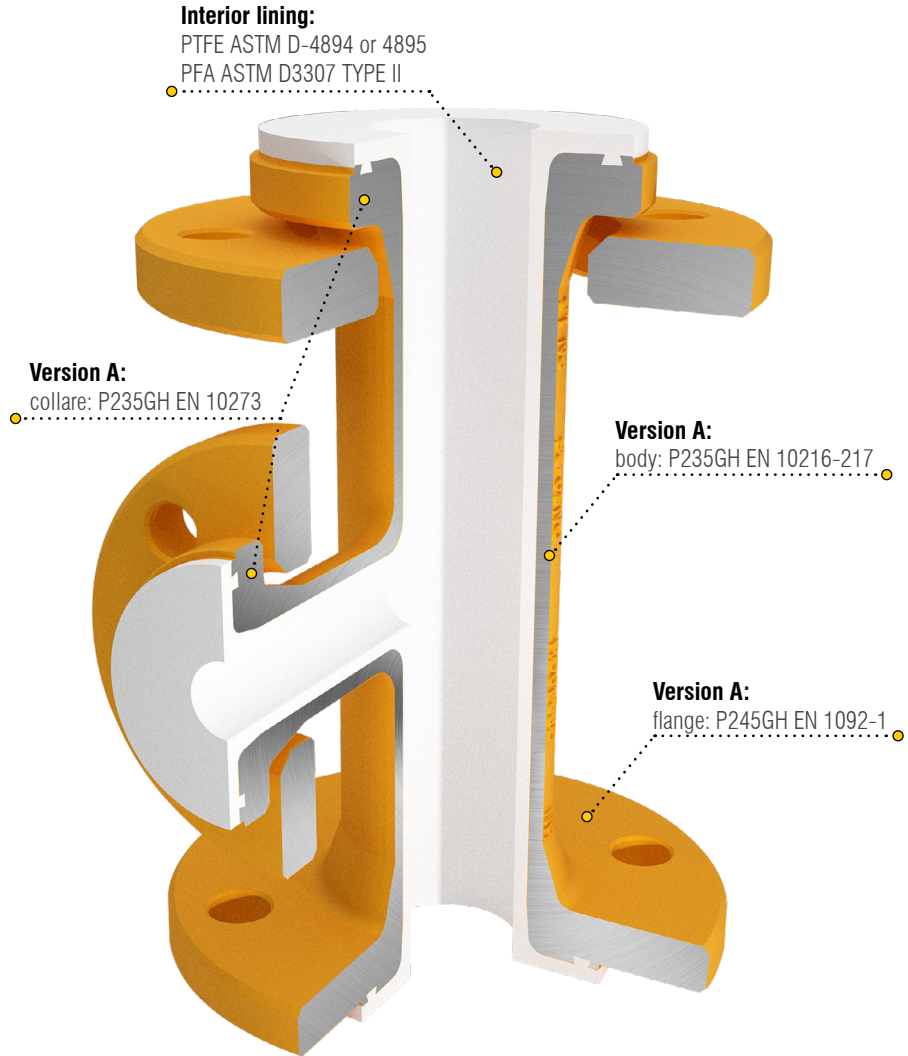

Reducing Tee in Antistatic version



#### Standard finishing:

gray epoxy-vinyl zinc paint

### Available on request



Approvals and Certifications



Quality and Special tests



Engineering Services



Special Supply



Stainless steel 304L/316L components



External Finiture

**PTFE - PFA REDUCING TEE  
DESIGN DIN 2448/2874 - CERTIFIED - 2014/68/EU (PED)**

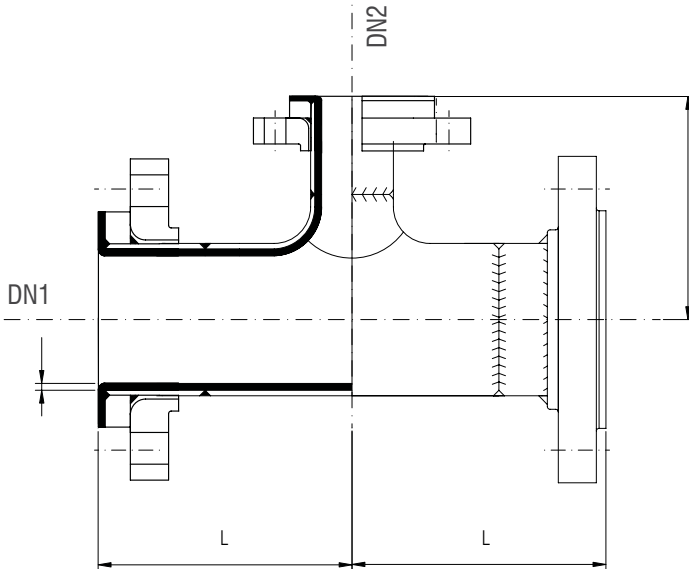

Dimension table to norm DIN 2448/2874

DN1	DN2	L1 mm	L2 mm	S ± 10% mm	Weight kg
20	15	95	80	4,0	3,1
25	15	110	80	4,0	3,7
	20		95		3,9
32	20	130	100	4,0	4,4
	25		110		5,2
40	15	150	80	4,0	5,3
	20		100		5,5
	25		110		5,7
	32		130		6,0
50	15	120	80	4,0	8,8
50x20	20	120	80		
	25		110		9,3
	32		130		9,5
50x40	40	120	150		
65	25	140	110	4,0	14,0
	32		130		14,0
	40		150		14,7

DN1	DN2	L1 mm	L2 mm	S ± 10% mm	Weight kg
	50		120		15,5
80	25	165	110	4,0	19,7
	40		150		20,4
	50	165	120	4,0	20,9
	65		140		21,8
100	25	205	110	4,5/4,0	31,4
	40		150		33,3
	50		120		34,1
	65		140		35,0
	80		165		36,0
125	65	245	140	5,0	49,0
	80		165		52,0
150	80	285	165	6,0	56,2
	100		205		77,0
	125		245		80,0
200	100	365	205	6,0	83,0
	125		245		125
	150		285		130
250	150	450	285	6,5	156
	200		365		161
300	150	525	285	6,5	165
	200		365		218
	250		450		222
350	150	600	285	6,5	205
	200		365		294
	250		450		300
	300		525		308
400	200	680	365	6,5	292
	250		450		356
	300		525		362
	350		600		370



DIN

index

previous view

**D2-37**  
data sheet

DIFLINE

**D2**

**□ PTFE - PFA REDUCING TEE  
DESIGN DIN 2448/2874 - CERTIFIED - 2014/68/EU (PED)**

**Technical specifications of Difline products**



**Pipes and Flanges dimensions according to DIN**



**Fittings dimensions according to DIN 2848**



**Operative Conditions**



**Bolt Torque**



**Finiture, Marking, Packing**



**Table of Chemical Resistance of Materials\***



**Available on request**



Approvals and Certifications



Quality and Special tests



Engineering Services



Special Supply



Stainless steel 304L/316L components



External Finiture